

You may want to print this information sheet and carry it with you until you are familiar with the system.

## Using the Keyless Entry key pad

Access to the Cabins at Earth & Soul Retreat is managed through the use of Keyless Entry Pin-Codes.



When your Cabin is prepared and ready for check-in you will receive an email and a text SMS confirmation with your personal 4-digit pin code (usually the last 4 digits of your mobile phone number).

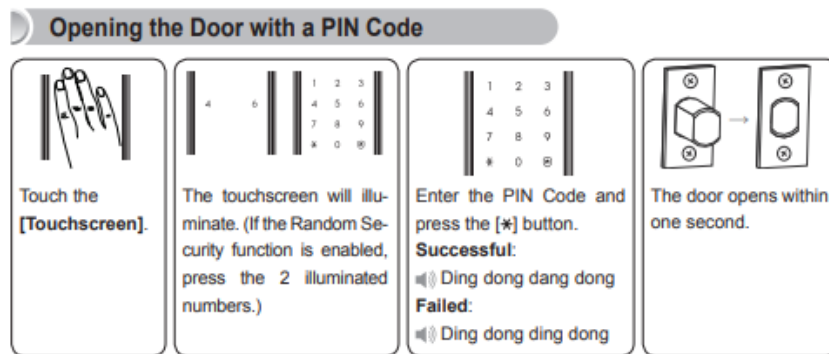

We do have the Random Security function enabled, so when you press the keypad two random numbers will be illuminated. Press these two numbers and then enter your pin-code, followed by the (\*) star button. The door will give you the appropriate musical tone. If successful, turn the handle and open the door.

### Automatic Locking

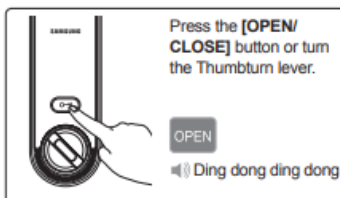

When you close the door, it will automatically lock. To open the door from the inside...

When you have entered the Cabin, access is available to the deck via two doorways that are opened from the inside using a nib-lock. Keys are not essential. The main entrance door is the only door that is not screened and we recommend that during your stay that you keep it closed reducing the entry of moths and insects etc.